

# SHAW TOWER SPECIFICATIONS

## ARCHITECTURAL DESIGN

### Design Philosophy

The 450-foot Shaw Tower is a slender, expressive form that tapers to the north to maximize water-front views and to introduce a sculptural silhouette on the Vancouver skyline. The building features a light, silvery palate of curtainwall and metal panel with trellised canopies capping the tower's form as it transitions from Live/Work to Office to Podium.

### Landscaping

- Two striking open plazas on the east and west provide bold and impressive entrances to Shaw Tower
- Main Arrival Plaza features a European-style drive court with vehicle drop-off area
- West Plaza separated from the street by a landscaped greenspace of honey locust trees with an illuminated, granite serpentine seat set in masses of spring-flowering azaleas
- The west garden is an inviting haven for pedestrians to stroll, relax or gather for outdoor events on the Plaza

## LOBBY

- Separate from the main office lobby
- 27-foot ceiling at main entry
- Internal pool with Koi fish, rocks and lights
- 18-foot water wall with split-faced basalt finish
- Oversized fireplace with custom mantel and finishes
- Two waiting areas with designer furniture
- Tree clusters and black bamboo groves
- Finishes include onyx and wood wall panels, stone slab, wood and glass flooring, textured metal mesh and back-painted glass

## AMENITIES

- Private 17-seat screening room arranged in a professional tiered-floor configuration
- State-of-the-art screening facility includes THX Ultra certified surround sound system and Sony 100" HDTV-capable big screen projection system with TouchScreen controller
- Furnished executive boardroom to conduct conferences
- Separate meeting room with furniture by Herman Miller and Nienkamper
- Fitted out kitchenette for entertaining in board-room and meeting room
- 3,900-square-foot health club featuring reception/waiting area, fully equipped exercise area, fitness room, massage room, steam room, change rooms and lockers

## WARRANTY

- Shaw Tower offers a 2-10-10 warranty provided by Willis Canada, one of the world's largest insurance brokers and risk consultants

2 Years	Materials and Workmanship Protection
10 Years	Water Penetration Protection
10 Years	Structural Protection
- Willis offers 10 years of water penetration coverage – twice the amount required by government legislation

## UNIT 4101

### INTERIOR

#### General

- Designed by Robert M. Ledingham Inc.
- Centralized air-conditioning/heating system using water source heat pumps
- Overheight solid core wood suite entry door
- V/C Stone quartzite split honed tile at suite entrance floor
- Overheight ceilings
- Tailored designer carpet in upgraded Walnut colour scheme
- Mirage engineered glued-down wood floor in upgraded Walnut colour scheme to living and dining
- 30" Optiflame electric fireplace
- High quality motorized roller shades with woven sun control fabric, and a second layer of motorized blackout blinds
- Two barbecue gas outlets in balcony
- 9" post-tensioned floor slab

### Appliances

- Sub-Zero 48" refrigerator with ice and water dispensers
- Wolf 48" gas stainless steel range
- Wolf 48" stainless steel 1200 cfm kitchen hood
- Fisher & Paykel double DishDrawer stainless steel dishwasher with two independent drawers, low water consumption and exceptionally quiet performance
- LG 2.1 cubic foot 1,000-watt stainless steel microwave with Intellrowave even heat system, easy defrost and recessed turntable
- Bosch H-Axis front loading washer and Bosch electric condensation dryer

### Kitchen

- Full-height wood cabinets in upgraded Walnut colour scheme
- Contemporary under-cabinet valence lighting
- Verde Sanfrancisco polished granite slab with honed edges countertop
- V/C Stone quartzite split honed floor tile
- Franke 1½ bowl sink
- Dornbracht sink mixer with rinsing headset

### Bathroom/Powder

- Verde Sanfrancisco polished granite slab with honed edges countertop
- V/C Stone quartzite split honed floor tile
- Vitreo mosaic glass wall tile from Italy
- Under-floor radiant heat in master ensuite
- Bette-Form tub from Germany
- Frosted glass wall to master ensuite and second bath
- Caroma Walvit wall-hung concealed tank water closet for master ensuite
- Caroma undercounter basins to baths
- Dornbracht bath fixtures from Germany
- Luna "Carlo Bartoli" bath accessories from Italy

## TECHNOLOGY

### Complete Home Cinema System

- Sony 50" plasma screen TV
- Parasound THX Ultra certified surround processor
- Parasound THX Ultra certified power amplifiers
- Sonance Cinema Series THX Ultra certified front channel loudspeakers
- Sonance Cinema dual powered subwoofer system
- Sonance in-ceiling surround speakers
- Sony ES progressive scan DVD/SACD player
- AMX ViewPoint Wireless TouchScreen remote control system
- Millson custom sliding equipment rack
- Millson custom rack mount equipment shelves
- Millson – MRBB equipment rack cabling termination enclosure
- Surgex A-1-1 certified AC power spike and surge protection
- Custom built-in home cinema millwork
- Custom installation and termination of ultra premium OFC speaker cables
- Custom installation and termination of hand made, broadcast quality A/V interconnect cables
- All required initial system prewire labour
- All required final installation and trim out labour
- All required initial programming and system calibration labour
- Personalized systems operation manual
- MillsonCare 1-year on-site extended warranty

### Complete Distributed Music System

- Fully integrated with residential automation system
- Features built-in two-way, flush mount ceiling speakers throughout your home
- Multi-zone power amplifier and system controller
- Convenient, wall mount audio control keypads
- Wireless, hand held system remote control
- 2 Sony 5 disc carousel CD changers
- 1 Parasound Reference Series radio tuner
- Built-in high quality speaker cables
- Highest quality interconnect cables
- All required prewire labour
- All required installation and trim out labour
- All programming and calibration labour
- Personalized systems operation manual
- MillsonCare 1-year on-site extended warranty

### Complete Lighting Control System

- Fully integrated with residential automation system
- Lutron remote control dimmers and switches
- Lutron 5 button wall mounted master keypad with raise and lower functions
- Lutron 10 button wall mounted master keypad with raise and lower functions
- Lutron 10 button cordless remote with raise and lower function
- Lutron Claro designer smooth faceplate covers
- All required prewire site coordination labour
- All required installation and trim out labour
- All programming and calibration labour
- Personalized systems operation manual
- MillsonCare 1-year on-site extended warranty

### Security

- Separate residential lobby with 24-hour concierge
- 24-hour digital video recording surveillance
- Video enterphone system allows identification/screening of guests
- Restricted floor access
- In-suite security system, fully installed, tested and programmed the day you move in

### LCD Flat Panel TV

- 15" high resolution LCD colour TV comes with hand held remote control
- All required low voltage A/V cabling
- All required prewire labour
- All required installation and trim out labour
- All programming and calibration labour
- MillsonCare 1-year on-site extended warranty

### Complete Residential Automation System

- AMX NetLink master control processor
- AMX 10" colour master control TouchPanel station
- AMX designer style LCD control keypads
- Fully integrated automation of thermostats for HVAC control
- Fully integrated automation of all power roller blinds
- Digital music hard drive library system
- Millson infrared repeater system
- Millson custom sliding equipment rack
- Millson custom rack mount equipment shelves
- Millson MRBB equipment rack cabling termination enclosure
- Surgex A-1-1 certified AC power spike and surge protection
- Custom installation and termination of ultra premium OFC speaker cables
- Custom installation and termination of hand made, broadcast quality A/V interconnect cables
- All required final installation and trim out labour
- All required initial programming and system calibration labour
- Personalized systems operation manual
- MillsonCare 1-year on-site extended warranty

## UNIT 4102/4103

### INTERIORS

#### General

- Designed by Robert M Ledingham Inc.
- Overheight solid core wood suite entry door
- European limestone/quartzite tile at suite entrance
- Overheight ceilings
- Tailored designer carpet in upgraded Walnut colour scheme
- 30" OptiFlame electric fireplace
- High quality roller shades with woven sun control fabric as well as a second layer of motorized blackout blinds in bedrooms

### Appliances

- Sub-Zero 36" custom-panelled refrigerator
- Fisher & Paykel 36" gas stainless steel cooktop with reversible wok burner and grate. Inset elements provide one of the sleekest cooktops on the market
- Fisher & Paykel 30" AEROflow Dynamic True Convection stainless steel oven with oversize opening
- Fisher & Paykel double DishDrawer stainless steel dishwasher with two independent drawers, low water consumption and exceptionally quiet performance

- LG 2.1 cubic foot 1,000-watt stainless steel microwave with Intellrowave even heat system, easy defrost and recessed turntable
- Faber Cristal 36" three-speed range hood fan with 500 cfm internal blower and heavy duty grease filters
- Bosch H-Axis front-loading washer and Bosch electric condensation dryer

### Kitchen

- Full-height wood cabinets in upgraded Walnut colour scheme
- Contemporary under-cabinet valence lighting
- Polished European granite slab countertop with honed edges
- European limestone/quartzite tile to floor
- Franke 1½ bowl sink
- Dornbracht sink mixer with rinsing headset

### Bathroom/Powder

- Polished European granite slab countertop with honed edges
- European limestone/quartzite tile flooring
- Vitreo mosaic glass wall tile from Italy
- Under-floor radiant heat in master ensuite
- BetteForm tub from Germany
- Frosted glass wall surround and sliding door to master ensuite
- Caroma Walvit wall-hung concealed tank water closet for master ensuite and powder
- Caroma Caravelle one-piece two button water closet for second bath
- Caroma Garnet undercounter elliptical vanity basin
- Caroma Liano undercounter gently curved geometric basin for powder room
- Dornbracht fixtures from Germany
- Luna "Carlo Bartoli" bath accessories from Italy

### Technology

- Shaw Tower's engineered cabling solution, included with every suite, features a fully integrated telecommunications cabling package
- A first in Vancouver, Shaw Tower will include a 100Mb local area computer network, fully installed and tested, with each live/work unit
- Residents will have a dedicated super-high-speed Internet connection right to their home, always on and capable of connection speeds up to 5Mbps
- Each suite includes a Shaw Digital Entertainment Terminal, programmed to deliver dozens of high quality, commercial free music channels
- High-speed Fujitec elevators with flush-mounted video displays delivering up-to-the-minute news, weather and market information
- Residents can choose from several customized Suite Technology Options, including:

- Three levels of dedicated Home Theatre featuring Sony Vega Plasma screen technology and THX Ultra certified audio components
- Multi-Room Distributed Music Systems with convenient keypad control
- Automated Lighting Control Systems that control lighting throughout the entire suite at the touch of a single button
- A completely integrated Suite Automation System, custom programmed to control systems throughout the entire suite

### LCD Flat Panel TV

- 15" high resolution LCD colour TV comes with hand held remote control
- All required low voltage A/V cabling
- All required prewire labour
- All required installation and trim out labour
- All programming and calibration labour
- MillsonCare 1-year on-site extended warranty

Exclusively marketed by  
Rennie Marketing Systems



# LIVING AT SHAW TOWER



LIVING STARTS ON 19 20 21 22 23 24 25 26 27 28 29 30 31 32 33 34 35 36 37 38 39 40 41 42



473 FEET LEVEL 41

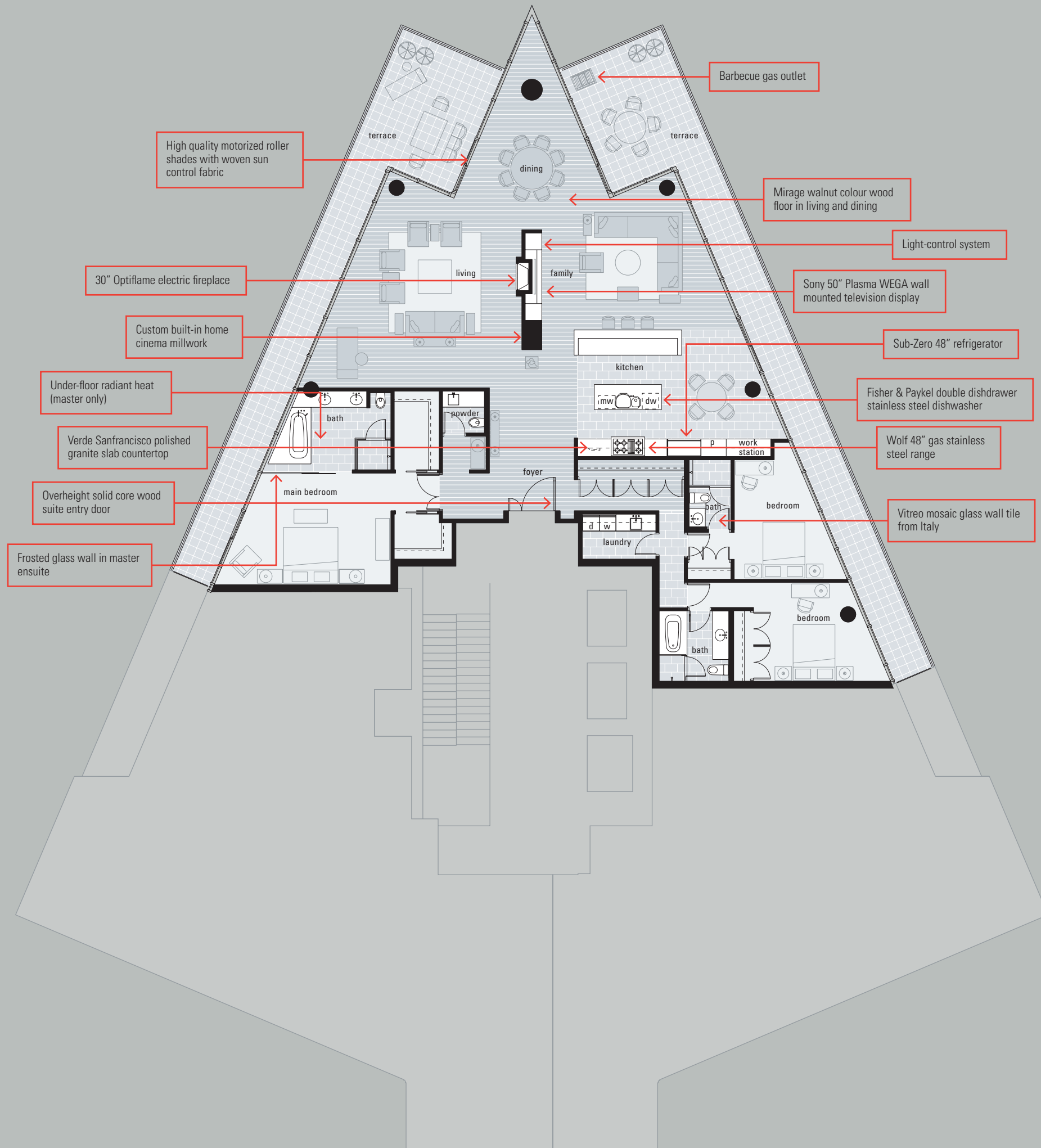

**UNIT 4101 PH**  
3 Bedroom 3062 sf

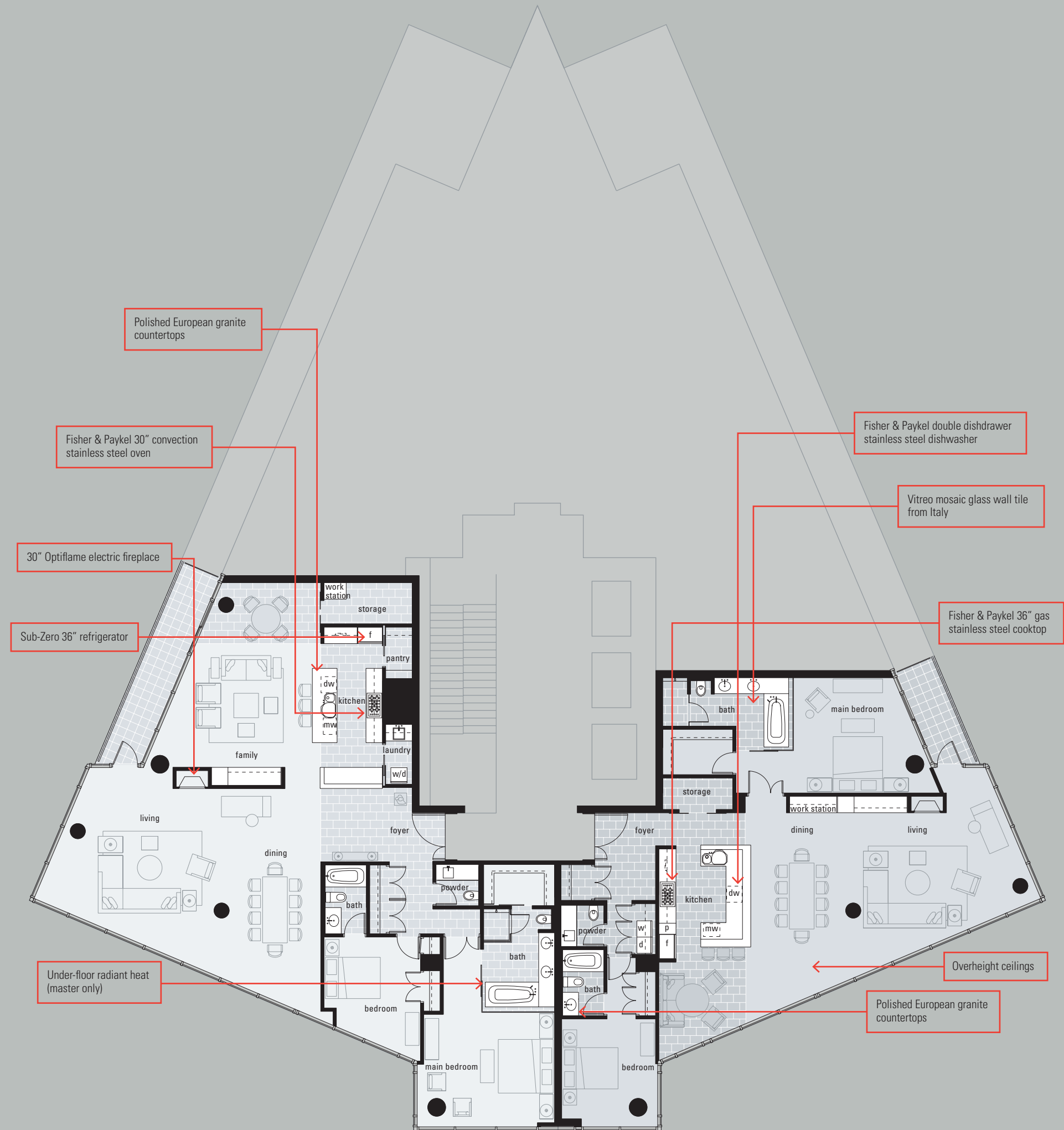

**UNIT 4102 PH**  
2 Bedroom 2361 sf

**UNIT 4103 PH**  
2 Bedroom 1963 sf

LIVING STARTS ON 19 20 21 22 23 24 25 26 27 28 29 30 31 32 33 34 35 36 37 38 39 40 41 42